

DOUBLE ACTING MEAT RAIL TRAFFIC DOOR

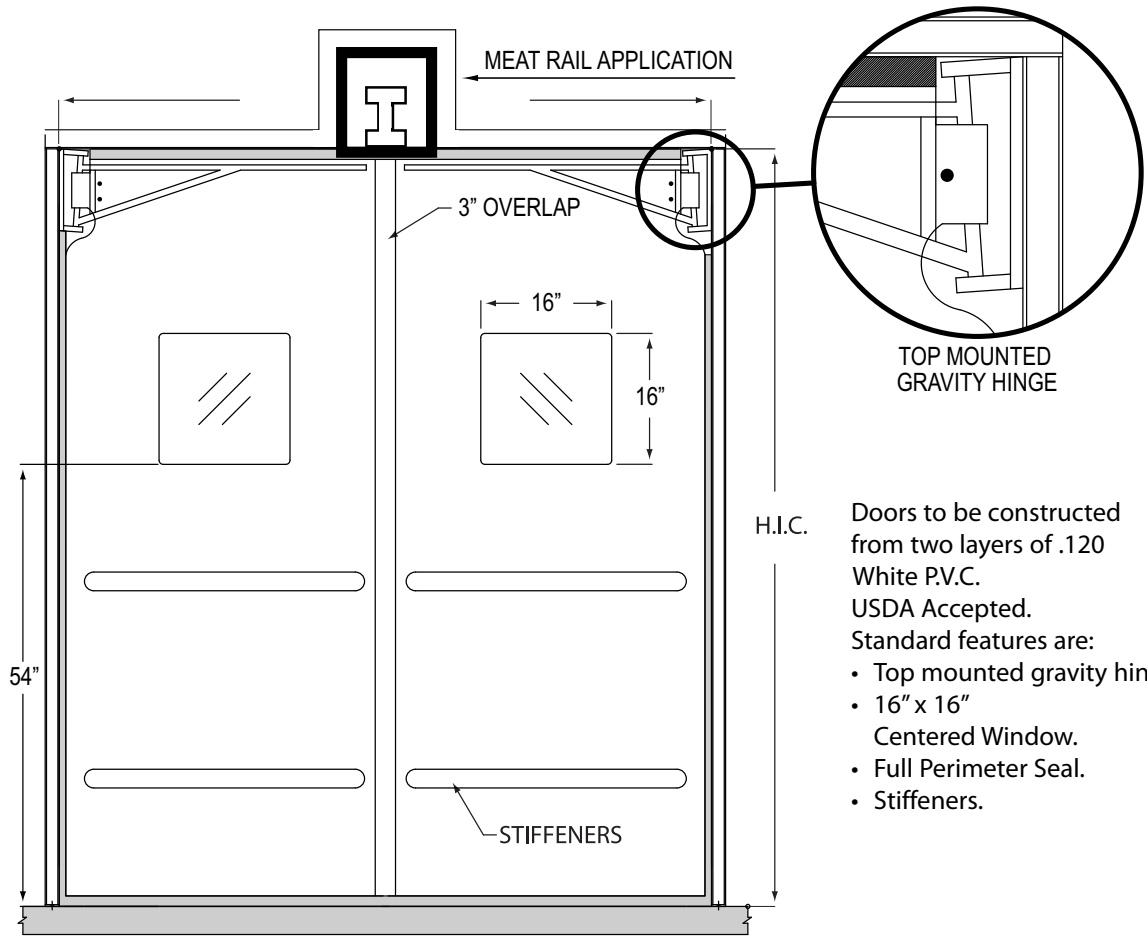

Doors to be constructed from two layers of .120 White P.V.C.
 USDA Accepted.
 Standard features are:

- Top mounted gravity hinges.
- 16" x 16" Centered Window.
- Full Perimeter Seal.
- Stiffeners.

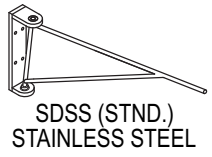

CUSTOM QUALITY PRODUCTS, INC.
 1645 Blue Rock Street
 Cincinnati, Ohio 45223
 800-635-1086
 513-541-1191
 fax: 513-541-1192
 www.cqpinc.com

DOOR SPECIFICATION
 Opening Width _____ x Height _____
 Qty. _____

BI-PARTING SINGLE PANEL
 L R

COLOR OPTION
 WHITE

WINDOW SIZES
 16"x16" (STANDARD)
 (OTHER)

WINDOW LOCATION
 CENTERED (STANDARD)
 OFFSET

Charges will be assumed by buyer for changes or cancellations to work in process. Buyer hereby accepts responsibility for all sizes and dimensions. This order will not be processed until all acknowledgement forms are signed and returned.

Specification accepted by: _____
 Date: _____

CQP-130 FLEX DOOR

 JOB NAME/LOCATION

 CUSTOMER/LOCATION

 CUST. ORDER NO.

 CUST. PO ORDER NO.